

B3HN6326SY



# Fitting Guide **HINO 300 4x4** **2017 On**

WINCH COMPATIBLE BULLBAR  
VEHICLE FRONTAL PROTECTION SYSTEM (VFPS)  
FOR AIR BAG & ADR COMPLIANT VEHICLES

# Index

---

## Pages 2-3

Stage 1 - Vehicle Preparation  
Stage 2 - Bumper Removal  
Stage 3 - Bumper Mount Removal  
Stage 4 - Tow Hook Removal  
Stage 5 - Headlight Wiring  
Stage 6 - Headlight Infill Prep

## Pages 4-5

Stage 7 - Headlight Infill Fitment  
Stage 8 - Retaining Bracket Fitment  
Stage 9 - Chassis Rail Preparation  
Stage 10 - Winch Frame/Chassis Mount Installation  
Stage 11 - Winch Frame/Chassis Mount Installation  
Stage 12 - Winch Frame/Chassis Mount Installation

## Pages 6-7

Stage 13 - Winch Frame/Chassis Mount Installation  
Stage 14 - Bullbar Installation  
Stage 15 - Finishing connections & Checks

## Pages 8-9

Fitting Kit  
Torque Guide  
Finished Product

**NOTE:** These instructions are to be used as a guide for installation of this component to the specified HINO model. Please ensure you check the component is applicability before installation. This work should be done by a qualified installer/technician and all care must be taken to ensure all steps are completed. Failure to do so may risk conformity to HINO component warranty and/or compliance. If you have any issues or concerns with this installation please contact 1300 01 HINO.

# The Benefits of Hino Parts

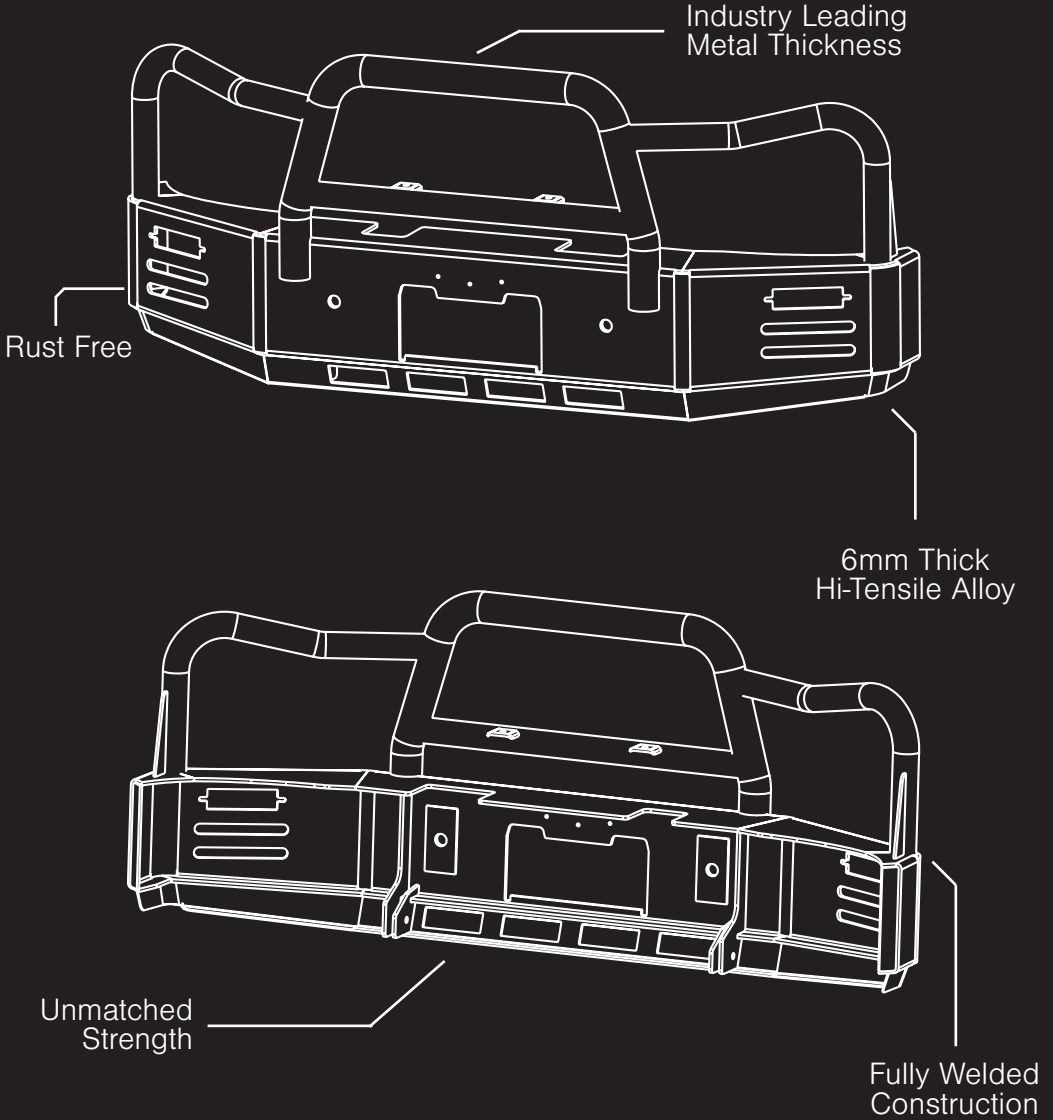

# BULLBAR

## Stage 1

- Park the vehicle on level ground and apply the park brake.
- Check installation hardware and read fitting instructions before commencing.



## Stage 2

- Remove six (6) M8 bolts from the front bumper.
- Metal hooks will retain bumper in position.
- Lift bumper to remove from hooks.



## Stage 3

- Located at the front end of chassis, release six (6) bolts retaining chassis adapter plates and remove.
- Retain bolts and discard adapter plates



# HINO 300 4x4

## Stage 4

- Remove tow hook and adapter from passenger side of the chassis rail.
- Discard adapter bracket, bolts and tow hook

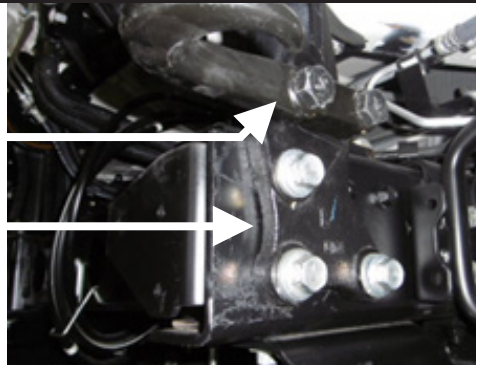

## Stage 5

- Un-clip indicator and park light harness from the rear of headlight assembly and attach the supplied indicator harness to indicator and park light plugs then the adapter plugs to the original light plugs.
- Remove indicator fitting from light and remove bulb. Refit light fitting without bulb.
- Image from under vehicle

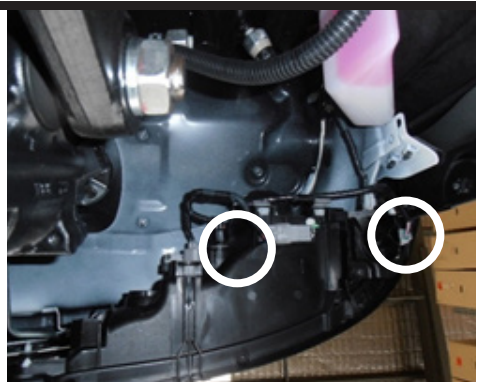

## Stage 6

- Remove the bolt on the lower outer edge of each head light and use to retain the infill strips under each head light.
- Install bolt into lower outer edge of headlight through infill panel. Finger tighten only.



# BULLBAR

## Stage 7

- Bend the infill strips around the lower edge of the light body and fasten using 1 – 3/16 x 3/4" metal thread and nyloc nut each side of the vehicle. Drill inner hole below headlight and fasten using 1 – 3/16 x 3/4" metal thread and nyloc nut.
- Fasten using 1 – 3/16 x 3/4" metal thread and nyloc nut.
- Tighten all bolts.

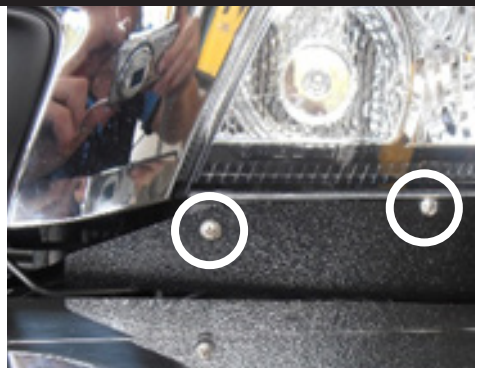

## Stage 8

- On centre of chassis cross member, Remove one 12mm original bolt retaining gear selector cables. Remove and discard original bracket.
- Install retaining bracket using original bolt. Ensure all cables are captured.

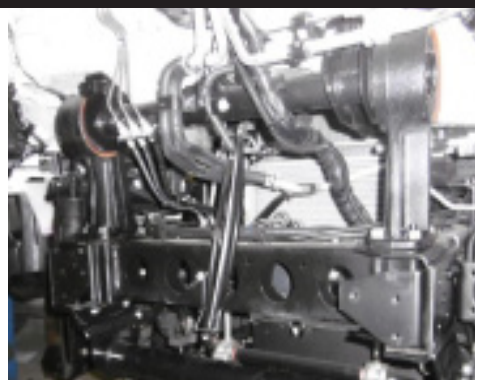

## Stage 9

- Remove (3) inner bolts from under the chassis each side, retain the front original long bolts only for re-use.

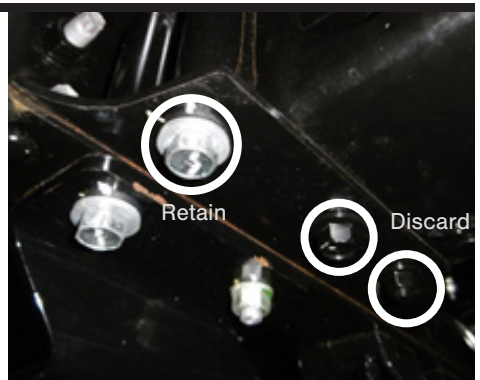

# HINO 300 4x4

## Stage 10

- Position the Winch frame/Chassis mount under the chassis.
- Align the slots and finger tighten using the original long bolts in original position.
- Fasten through the rear holes using M14 x 50 x 1.5 bolt, spring, flat washers and nuts on middle holes and M12 x 50 x 1.25, spring, flat washers and nuts on rear holes

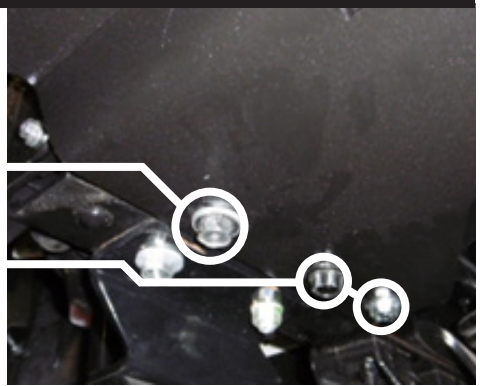

## Stage 11

- On the passenger side of the vehicle, align the Winch frame/Chassis mount with the captive nuts in the chassis rail, finger tighten using large 3 hole washer plate, 3 – M14 x 50 x 1.5 bolts, spring, flat washers.



## Stage 12

- Align the Winch frame/Chassis mount with the captive nuts in the chassis end, finger tighten using (3) original bolts and 3 hole chassis mount plate each side.





# BULLBAR

## Stage 13

- On the driver side of the vehicle, fasten the angle bracket using M12 x 50 x 1.25 bolt, spring, flat washers and nut through the Winch frame/ Chassis mount. Using the hole in the chassis mount and angle bracket, drill 13mm holes through the chassis rail on side and top. Fasten using M12 x 50 x 1.25 bolt, spring, flat washers and nuts.
- Paint or rust proof all exposed metal.
- Level and tighten all fasteners. Reference torque guide.

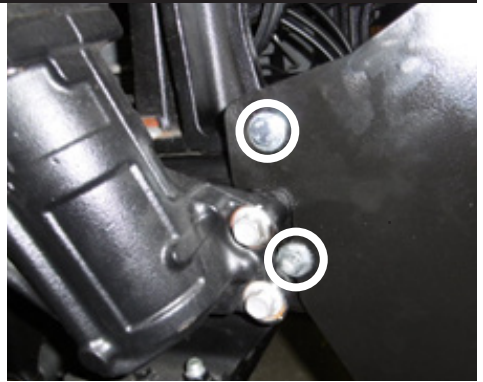

## Stage 14

- Fit the Bullbar onto the chassis mounts and fasten through the hinge holes using 9/16" x 2-1/2" UNC bolts, flat washers and nyloc nuts.
- Note: Manually tighten the hinge bolt. Ensure nuts just bear on the flat washer lightly.





# HINO 300 4x4

## Stage 15

- Connect the supplied indicator harness to indicator and park light plugs fitted to the Bullbar.
- Cable tie the indicator harnesses.
- Note: Allow enough length for the Bullbar to tilt without the cable tightening causing damage.
- Apply the tilt cab sticker above cabin tilt lever if required.
- Check the operation of all lights.
- Tilt protection into position and install eyebolts and washers. Tighten firmly.
- Install numberplate hinge to protection bar (Fig.7) 3 - M6 x 20 bolts, Flat washers and nyloc nuts.



## Supplied Product Assemblies

Fig.1 - 1x Bullbar assembly

Fig.2 - 1x Mount assembly (Picture from rear) (Fitted to Bar)

Fig.3 - 1x Angle bracket(B3HN6325SY\_F10MS)

Fig.4 - 2x 3 hole Chassis mount washer plate. (B3HN6325SY\_B3MS)

Fig.5 - 1x 3 hole large washer plate (B3HN6325SY\_B6MS)

Fig.6 - 1x Pair Infill panels 2014+ High Horsepower

Fig.7 - 1x Numberplate Hinge

Fig.8 - 1x Retaining Bracket (B3HN6325SY-C3MS)

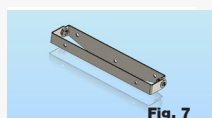
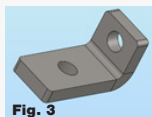
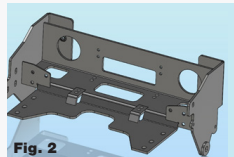
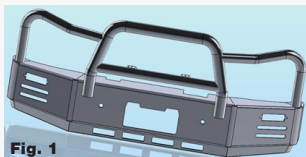

# Fitting Kit

## Pre-Fitted Bolts & Parts

2 – 9/16" x 2-1/2" UNC hex bolts  
(Fitted to Bullbar)

2 – 9/16" UNC Nyloc nuts (Fitted to Bullbar)

4 – 9/16" flat washers (Fitted to Bullbar)

2 – 3/4" Eyebolts (Fitted to Bullbar)

2 – 3/4" Flat washers (Fitted to Bullbar)

1 – Pair incandescent Indicator/Park light Assemblies (fitted to Bullbar)

4 – 6mm Air Vents

## Installation Kit

5 – M14 x 50 x 1.5 hex head bolts

7 – M14 flat washers

5 – M14 spring washers

2 – M14 x 1.5 nuts

5 – M12 x 50 x 1.25 hex head bolts

10 – M12 flat washers

5 – M12 spring washers

5 – M12 x 1.25 nuts

7 – 3/16" x 3/4" SS pan head metal threads

7 – 3/16" x 3/4" SS nyloc nuts

6 – 3/16" Washers

2 – Patch Harnesses supplied (IC20HI300IPH)

4 – Cable ties 150mm long

1 – Tilt cab Sticker

3 – M6 x 20 Bolts

6 – M6 Flat Washers

3 – M6 Nylocs

## Torque Guide

Diameter	Thread Pitch	Reccomended Assembly Setting	
M6	1.0mm	9.1Nm	6.8lbft
M8	1.25mm	22Nm	16.3lbft
M10	1.5mm	44Nm	33lbft
M12	1.75	76Nm	57lbft
1/4"	UNC	14Nm	10lbft
5/16"	UNC	29Nm	21lbft
3/8"	UNC	51Nm	38lbft
1/2"	UNC	125Nm	92lbft
9/16"	UNC	442Nm	326lbft

# Finished Product

---



REPLACES: 06.11.20

REVISED: 18.11.17