

GA32002003
(B3HN6351SY)



Fitting Guide

HINO 300 STANDARD CAB

6/20 ON

Tubular Fleet Bar
VEHICLE FRONTAL PROTECTION SYSTEM (VFPS)
FOR AIR BAG & ADR COMPLIANT VEHICLES

Index

Pages 2-3

Index and Notes

Pages 14-15

Finished Product

Pages 4-5

Stage 1 - Vehicle Preparation
Stage 2 - Bumper Cover Removal
Stage 3 - Air Box Bracket Removal
Stage 4 - Tow Hook Relocation
Stage 5 - Sonar Lens Removal
Stage 6 - Sonar Lense Relocation

Pages 6-7

Stage 7 - Steel Mount Fitment
Stage 8 - Splash Guard Installation
Stage 9 - Steel Mount Alignment
Stage 10 - Air Box Bracket Refitment
Stage 11 - Sonar Lense Installation
Stage 12 - Remove Grille

Pages 8-9

Stage 13 - Disconnect Light
Stage 14 - Remove Light
Stage 15 - Remove Bulb
Stage 16 - Refit Light and Grille
Stage 17 to 18 - Remove Connector

Pages 10-11

Stage 19 to 20 - Refit Connector
Stage 21 - Bull Bar Hinge Bolt Installation
Stage 22 - Cabin Tilt Check
Stage 23 - Eye Bolt Installation
Stage 24 - Finishing, Checks and Tilt Sticker

Pages 12-13

Supplied Product Assemblies

Fitting Kit
Torque Guide

NOTE: These instructions are to be used as a guide for installation of this component to the specified HINO model. Please ensure you check the component is applicability before installation. This work should be done by a qualified installer/technician and all care must be taken to ensure all steps are completed. Failure to do so may risk conformity to HINO component warranty and/or compliance. If you have any issues or concerns with this installation please contact 1300 01 HINO.

Model Code Check

- This product is designed to be installed on the following model codes.
- Please ensure the vehicle you are working on is listed below.
- If not please contact your parts manager before you proceed

Model description	Model code
STD CAB	XZU605 / 655
STD CAB - TRADE ACE	XZU605 / 655

GA32002003

Stage 1

- Park the vehicle on level ground and apply the park brake.
- Check installation hardware and read fitting instructions before commencing.
- Ensure all equipment in cabin is correctly secured or in a position so cab can be tilted.
- Remove steel mount from bullbar. Retain fasteners for refitment.



Stage 2

- Remove three (3) 10mm head bolts from bumper opening between foglights per/ side.
- Remove two (2) 12mm head bolts from rear of plastic splash guard.
- Unplug wiring loom and remove bumper.



Stage 3

- Remove two (2) 12mm head nuts from front of air box, one (1) 14mm head bolt from wire bracket.
- Remove two (2) 12mm head nuts from side of chassis rail.
- Remove bracket.

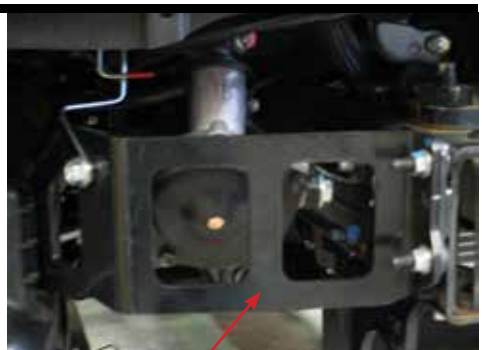

Bracket to be removed.

HINO 300 NARROW CAB

Stage 4

- Remove tow hook from passengers side, two (2) 19mm head bolts.
- Install tow hook to steel mounting bracket with M14 x 1.5 x 70 bolts, flat washers and nyloc nuts.

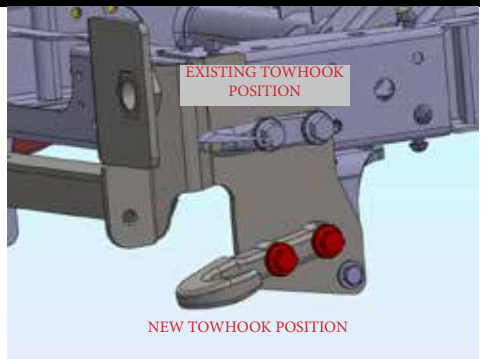

Stage 5

- Remove three (3) phillips head screws from sonar lens.



Stage 6

- Relocate lens onto alloy mounting bracket using three (3) M6 x 16mm bolts, flat washers and nyloc nuts.



GA32002003

Stage 7

- Fit steel mounting bracket onto chassis rails using six (6) M8 x 1.25 x 35mm bolts, spring washers, flat washers and washer plate in front holes on crossmember.
- Install two (2) M10 x 1.25 x 35mm bolts, spring washers and square flat washers on drivers side.
- Install two (2) M14 x 1.5 x 40mm bolts, flat washers, spring washers and one (1) M10 x 1.5 x 35mm bolt, flat washers and nyloc nut on passengers side..

NOTE: Rear hole has captive nut on passenger side.



Stage 8

- Remove plastic splash guard from front bumper.
- Using lower front bolt of steel mount at chassis, fit underbelly splash guard brackets using M8 x 1.25 x 35mm bolts, spring washers and flat washers previously installed.
- Fit plastic splash guard with two M8 x 1.25 x 30mm bolts, flat washers and nyloc nuts. Fit original bolts in rear holes.



Stage 9

- Align mount so front of mount is vertical and horizontally to match body of truck.
- Tighten all bolts



HINO 300 NARROW CAB

Stage 10

- Refit air box bracket with original equipment nuts and bolts.



Stage 11

- Fit sonar lens mount onto steel mounting brackets using two (2) M6 x 30mm bolts, spring washers and flat washers.



Stage 12

- Remove one 10mm head bolt from centre of grille.
- Gently pull grille forward from the vehicle.
- Remove grille.

NOTE: Grille attaches up over headlights. Care needs to be taken when removing not to overstress these areas.



GA32002003

Stage 13

- Disconnect head lights on the vehicle, three connectors.
- Press the release tab on the connector and gently pull apart.



Stage 14

- Whilst supporting light, remove two 10mm head bolts from inside of light and one 10mm head bolt from lower outer corner.
- Remove light from vehicle.



Stage 15

- Remove indicator fitting from light and remove bulb. Refit light fitting without bulb.



HINO 300 NARROW CAB

Stage 16

- Refit light to vehicle using original equipment bolts



Stage 17

- Locate the vehicle side connector for the parking light.
- Using a small jewelers screwdriver or thin sharp object, remove plastic security tab from front of connector.



Stage 18

- Whilst placing gentle pressure on the wiring, slide small screwdriver down edge of terminal and release locking tab from terminal.
- Wiring should slide rearward in connector.
- Remove wiring from connector.

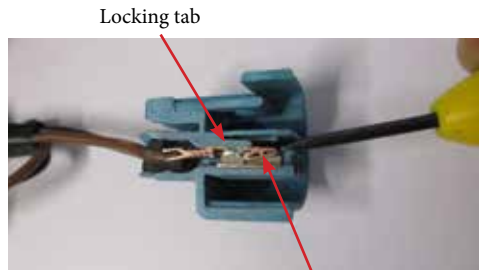

Locking tab
Metal terminal
Cut away view of connector



GA32002003

Stage 19

- Place wiring into rear of connector supplied with patch harness kit so positive wires connect when harness mate together.
- Slide wiring home in connector until the internal locking tabs engage. A small clicking sound should be heard.



Close up of terminal showing locking tab area

Stage 20

- Reinsert plastic security tab into connector. Gently push security tab home in plug.
- Connect wiring and test for correct connections.



Stage 21

- Place the Bullbar onto the chassis mounts and install the M14 x 70mm hinge bolts, flat washers and nyloc nuts and fasten until light pressure is applied on the alloy mount plates.

Warning: Do not over tighten the hinge bolts.



HINO 300 NARROW CAB

Stage 22

- Tilt cabin to ensure cabin locks into position and does not hit bullbar.
- Connect wiring to park/indicator. Zip tie wiring harness to the original on the underside of the headlight. Ensure wiring is not tight when bull bar is tilted.
- Return cabin to locked position.



Stage 23

- Carefully lift bullbar and check positioning of sonar guard. Adjust if required.
- Fit locking bolts, steel washer and nylon washer. Tighten firmly using wheel nut wrench from tool kit of vehicle.

WARNING: Do not over tighten bolt.



Stage 24

- Check all electrical equipment for correct operation.
- Place cab tilt sticker onto vehicle near cab lock down handle.

NOTE: Two (2) M5 x 12 screws and nyloc nuts have been included for installation of the number plate. Please ensure they are attached to the number plate bracket on the bullbar.

GA32002003

Supplied Product Assemblies

Fig.1 - 1x Bullbar assembly	Fig.4 - 2x Underbelly splash guard brackets
Fig.2 - 1x Steel mounting bracket (Fitted to Bar)	Fig.5 - 2x Chassis Washer plates
Fig.3 - 1x Alloy lense mounting bracket	



Figure 1 - Bullbar assembly

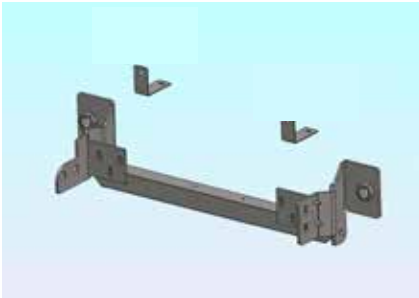

Figure 2 - Steel mounting bracket (fitted to bar)



Figure 4 - Underbelly splash guard brackets



Figure 3 - Alloy lense mounting bracket (fitted to bar)



FIGURE 5 - Chassis Washer plates

Fitting Kit

Pre-fitted bolts and Parts

1 - Steel mounting bracket	2 - M6 spring washers (used to secure alloy lens bracket)
1 - Alloy lense mounting bracket	
1 - Sonar Guard	6 - M6 flat washers (used for alloy lens and sonar)
2 - M14 x 1.5 x 70mm ¹ hex bolts (used for hinge bolt)	4 - M6 Nyloc nuts
4 - M14 flat washers (used for hinge bolt)	4 - 3/16 X 3/4 stainless PK screws
2 - M14 x 1.5 Nyloc nuts (used for hinge bolt)	4 - 10-24 stainless nyloc nuts
2 - M27 x 1.5 x 70mm Bolts ² (used in eye bolt holes)	8 - 4mm Starlock fasteners (used to attach lettering)
2 - M27 Nylon washers (used in eye bolt holes)	1 - Hino Lettering
2 - M27 Flat washers (used in eye bolt holes)	2 - Incandescent park / indicator
6 - M6 X 25 Black combo bolts	

Fitting Kit

2 - Chassis washer plates	6 - M8 X 35 bolt
2 - Underbelly splash guard brackets	10 - 5/16 x 1 x 16 flat washers
2 - M14 x 1.5 x 70 bolts (grade 10.9)	6 - M8 spring washers
2 - M14 x 1.5 x 40mm bolts	2 - M8 nyloc nuts
5 - M14 flat washers	3 - M6 x 16 Black Phillips screw
1 - M14 spring washers	6 - M6 flat washers
5 - M14 x 1.5 Nyloc nuts (2 nuts to replace shipping nuts)	3 - M6 nyloc nuts
1 - M10 x 1.5 x 35mm bolts	2 - M5 x 12 stainless PK screws
2 - M10 x 1.25 x 35mm bolts	2 - M5 stainless nyloc nuts
4 - M10 Flat washers	2 - Quick Click harness (IC20HI300NAIPH)
2 - M10 Spring washers	6 - 300mm zip ties
1 - M10 x 1.5 Nyloc nut	1 - Tilt sticker
2 - M8 x 1.25 x 30mm bolts	

Torque Guide

Diameter	Thread Pitch	Recomended Assembly Setting	
M6	1.0mm	9.1Nm	6.8lbft
M8	1.25mm	22Nm	16.3lbft
M10	1.5mm	44Nm	33lbft
M14 ¹	1.5mm	122Nm ¹	90lbft ¹
M27 ²	3mm	Hand tightened firmly only as overtightening will damage nylon washer	

Notes:

1. M14 bolts used to secure bullbar to steel mount require to be tightened only to touch the alloy mount firmly. Overtightening of this bolt will result in damage to the bullbar and possible inability to align bullbar correctly to vehicle.

2. M27 bolts are used as securing bolts for the bullbar. This allows the bullbar to be release from the vehicle using the wheel spanner of the vehicle. Overtightening of this bolt will damage the nylon washer causing possible vibration rattles to develop.

Finished Product



REPLACES: 00.00.00

REVISED: 22.07.20