

GA50002043

GA10002008



# Fitting Guide

## **HINO 500 STANDARD CAB**

### **MY19 MODEL**

4 Post Bullbar with Towpin Mount  
VEHICLE FRONTAL PROTECTION SYSTEM (VFPS)  
FOR AIR BAG & ADR COMPLIANT VEHICLES

# Index

---

## **Pages 2-3**

Index and Important Information

## **Pages 4-5**

Stage 1	Vehicle Preparation
Stage 2	Bumper End Cover Removal
Stage 3	Bumper Step cover removal
Stage 4	Bumper Plastics Removal
Stage 5	Bumper Plastics Removal
Stage 6	Bumper Plastics Removal

## **Pages 6-7**

Stage 7	Wiring Harness Preparation
Stage 8	Headlight removal
Stage 9	Sensor, Towhook and Temperature Sensor Removal
Stage 10	Grille Support Bracket Removal
Stage 11	Steel Towpin Mount Bracket Installation
Stage 12	Sensor and Temperature Sensor Refitment

## **Pages 8-9**

Stage 13	Headlight Installation and Wiring
Stage 14	Bullbar Installation
Stage 15	Finishing, Checks and Alignments

Supplied Product Assemblies

## **Pages 10-11**

Fitting Kit
Torque Guide
Finished Product

**NOTE:** These instructions are to be used as a guide for installation of this component to the specified HINO model. Please ensure you check the component is applicability before installation. This work should be done by a qualified installer/technician and all care must be taken to ensure all steps are completed. Failure to do so may risk conformity to HINO component warranty and/or compliance. If you have any issues or concerns with this installation please contact 1300 01 HINO.

# Important Information:

This bullbar has been designed to allow the vehicle operator to use the wheel brace to tilt the bullbar for access to the engine compartment.

As the lug nuts are different from the FC-FD models to the FE Model the front bolt of the bullbar may require to be changed to suit, both bolts and nut plates are included with this bullbar.

Please check and install:

FC - FD model - 41mm front bullbar bolt and nut plate installed on steel mounting brackets.

FE model - 33mm bullbar tilt bolt and nut plate supplied in kit.

Unbolt nut 41mm nut plate installed on steel mounting brackets four (2) M8 x 25mm countersunk bolts each side. Attach 33mm (angled corner) nut plates with removed M8 x 25mm countersunk bolts, flat washers and nyloc nuts.

NOTE: Bolt used should match wheel nuts - check with wheel brace in vehicle.

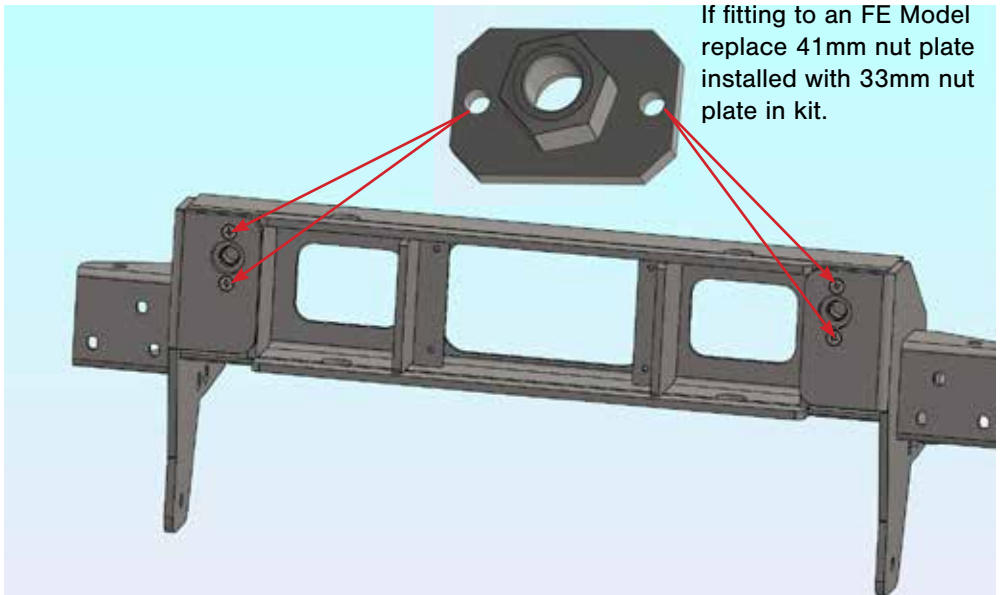

# GA50002043 / GA10002008

## Stage 1

- Park the vehicle on level ground and apply the park brake.
- Check installation hardware and read fitting instructions before commencing.
- Lift bonnet.



## Stage 2

- On end covers of bumper, remove two (2) push pull clips and one (1) 10mm head bolt on underside.
- Remove end cover.
- Remove two (2) 10mm head screws from behind covers.



## Stage 3

- On front of bumper at ends of step, gently pull plastic cover forward.
- Remove covers.



# HINO MY19 500 SERIES STANDARD CAB

## Stage 4

- From underside of bumper remove seven (7) 10mm head screws.



## Stage 5

- From bumper behind number plate, remove one (1) 10mm head bolt.
- Remove four (4) 10mm head bolts from behind of top center grille.
- Gently pull on ends of centre grilles to remove.



## Stage 6

- Remove two (2) plastic push pull clips from inner edge of headlight panel. Gently pull to remove headlight panel.



# GA50002043 / GA10002008

## Stage 7

- From behind bumper support panel, remove one (1) 10mm head bolt for wiring harness retaining bracket.



## Stage 8

- Unplug headlights from wiring.
- Unclip wiring and remove center grille from vehicle. Two (2) 14mm head bolts, two (2) 12mm head bolts and one (1) 14mm head nut (per side).
- Remove headlights and headlight mounting brackets from chassis rail bracket.

**NOTE:** It is easiest to remove all the bolts from the front leaving the top bolt till last. Ensure lights are supported when removing.



## Stage 9

- Remove sensor from left hand of chassis.

**CAUTION:** Do not hit or drop sensor.

- Remove tow hook from top of left hand chassis rail, two (2) 22mm head bolts.
- On right hand side of chassis, unplug and remove temperature sensor.

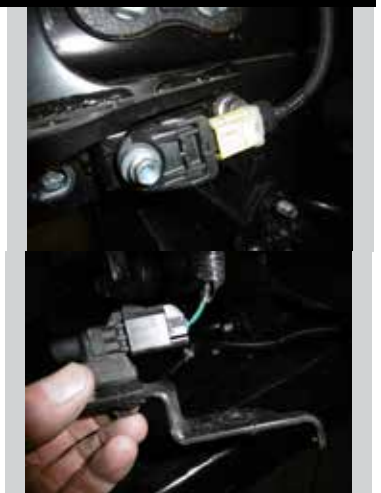

# HINO MY19 500 SERIES STANDARD CAB

## Stage 10

- Remove grille support brackets from under headlights, two (2) 10mm head bolts.



## Stage 11

- Install steel towpin mount bracket to chassis rails using three (3) M12 x 1.25 x 40 bolts, spring washers and flat washers into captive nuts and two (2) M12 x 1.25 x 40 flat washers, spring washers and nyloc nuts for top holes (per side).
- Using a level, align steel mounting brackets to vertical on the front face and horizontal across the top of the steel mounting brackets.
- **Tighten all bolts**
- **Check front bolts in bullbar match wheel nuts. Should the bolt head size not match, change rear nut plate by removing two (2) countersunk screws (per side) and reinstalling new plate.**

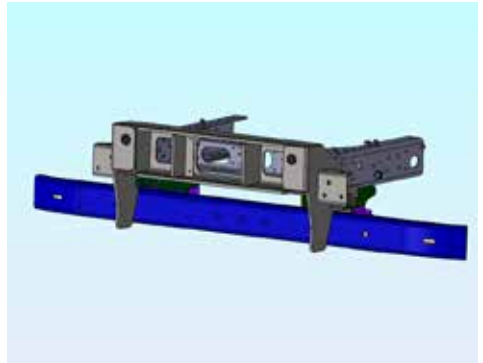

**Caution: Mounting bracket fits around sonar unit. Be sure not to knock or damage unit.**

## Stage 12

- Refit sensor to left side of steel mounting bracket using M6 x 25 bolt, flat washer and nyloc nut.



# GA50002043 / GA10002008

## Stage 13

- Fit temperature sensor to the drivers side steel mounting brackets using M6 x 25 bolt, flat washer and nyloc nut.
- Install headlights to steel mounting brackets using five (5) M10 x 1.5 x 50 bolts, flat washers and nyloc nuts (supplied).
- **Tighten all bolts.**
- Reconnect wiring to lights and secure wiring to chassis using zip ties (supplied).



## Stage 14

- Install Bullbar
- Align front bolt holes in channel and fit the applicable size bolt to suit the wheel brace in the truck FC-FD models M27 x 70mm bolt, nylon washer and flat washer, FE 7/8 x 2.5 bolt, M24 nylon washer and flat washer.
- Fit hinge bolts to lower mount hole using M16<sup>1</sup> x 70 bolts, flat washers and nuts (supplied).
- Hand tighten M16<sup>1</sup> bolts to be firm to alloy only. **DO NOT OVERTIGHTEN.**



## Stage 15

- Check and align lights to correct levels.
- Tilt bar to ensure clearance of lights and cabin.
- Place tilt warning sticker in a prominent position on rear of cabin next to the tilt release lever.
- Install Towpins into top of channel through steel tow mount. Head of towpin sits on top of channel.





# HINO MY19 500 SERIES STANDARD CAB

## Supplied Product Assemblies

1x Towpin mounting bracket (Fitted to Bar)

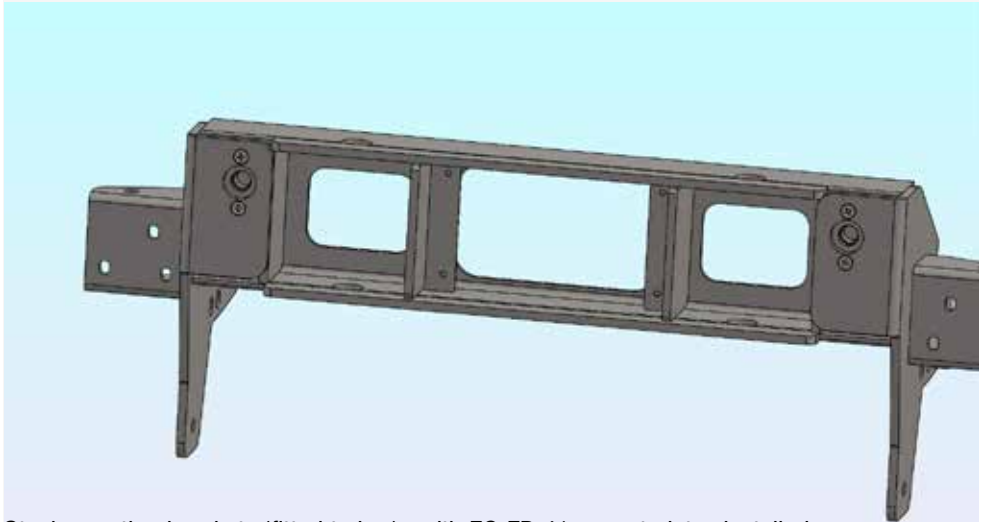

Steel mounting brackets (fitted to bar) - with FC-FD 41mm nut plates installed

## Torque Guide

Diameter	Thread Pitch	Recommended Assembly Setting	
M6	1.0mm	9.1Nm	6.8lbft
M8	1.25mm	22Nm	16.3lbft
M10	1.5mm	44Nm	33lbft
M12	1.25mm	76Nm	57lbft
M16 <sup>1</sup>	2mm	190Nm <sup>1</sup>	140lbft <sup>1</sup>
7/8	9 TPI	Hand tightened firmly only as overtightening will damage nylon washer	
M27	3mm		

Notes:

1. M16 bolts used to secure bullbar to steel mount require to be tightened only to touch the alloy mount firmly. Overtightening of this bolt will result in damage to the bullbar and possible inability to align bullbar correctly to vehicle.

# Fitting Kit

**GA50002043 / GA10002008**

## Pre-fitted bolts and Parts

1 - Tow pin mounting bracket (YP4HN6551TSYF)	4 - M8 x 25mm countersunk bolts (used for nut plates)
1 - Perspex sonar cover (P4HN6551_A2PL) (fitted to mount)	4 - M8 flat washers (used for nut plates)
2 - M16 x 2.0 x 70mm hex bolts (used for hinge bolts)	4 - M8 Nyloc nuts (used for nut plates)
2 - M16 x 2 Nyloc nuts (used for hinge bolts)	2 - Black plastic steps
2 - M16 flat washers (used for hinge bolts)	8 - M6 x 25mm combi bolts (used to attach sonar cover to mount and steps to bar)
2 - M27 nut plates (square corner fitted to mount)	8 - M6 flat washers (used to attach sonar cover to mount and steps to bar)
2 - M27 x 70mm hex bolts (used in tilt bolt holes)	8 - M6 nyloc nuts (used to attach sonar cover to mount and steps to bar)
2 - M27 Flat washers (used in tilt bolt holes)	1 - Hino Lettering
2 - M27 Nylon washers (used in tilt bolt holes)	8 - 4mm Starlock fasteners (used to attach lettering)

## Fitting Kit

2 - 260mm tow pins	4 - M12 x 1.25 nyloc nuts
2 - M33 x 60 x 5 nylon towpin washers (fitted to towpin)	10 - M10 x 1.5 x 50mm bolts
2 - 7/8 nut plate (angled corner)	20 - M10 flat washers
2 - 7/8 x 2.5 bolts	10 - M10 x 1.5 nyloc nuts
2 - M24 nylon washers	2 - M6 x 25mm bolts
2 - M24 flat washers	2 - M6 flat washers
2 - M16 x 2 nyloc nuts (replacements for hinge bolt nuts if required)	2 - M6 nyloc nuts
10 - M12 x 1.25 x 40mm bolts	4 - M8 nyloc nuts (for nutplates if required)
14 - M12 flat washers	6 - 300mm zip ties
6 - M12 spring washers	1 - Tilt sticker

# Finished Product

---



REPLACES: N/A  
REVISED: 10.12.21

